

# PITCHED ROOF FISH CLEANING TABLE - DISABLED ACCESSIBLE

## DEPARTMENT OF PRIMARY INDUSTRIES

### DRAWING LIST

- 201: Drawing List and Information
- 202: Two Person Pitched Roof
- 203: Four Person Pitched Roof
- 204: Eight Person Pitched Roof
- 205: Pitched Roof Sections and Detail
- 206: Notes

### INFORMATION

The fish cleaning facility offers considerable flexibility in its size and design to cater to a variety of user requirements and settings. The following information sets out key considerations to assist with their selection and placement.

#### TABLE SIZE

The standard sizing of the tables covers eight, four and two people settings. The choice of size will depend on the frequency of use by anglers at a particular site as suggested below:

- Eight people setting to be used in high use areas such as:
- Fishing clubs with a large patronage;
  - Purpose-built boating facilities with launching ramps and large car and trailer parking facilities;
  - Locations where angling competitions are held; and
  - Locations where existing facilities are inadequate resulting in the inappropriate use of other recreational facilities.

- Four people setting to be used in medium use areas such as:
- Fishing clubs with a medium patronage;
  - Multi-purpose recreational areas that incorporate boat launching ramps and shared car and trailer parking facilities; and
  - Locations which are popular with recreational anglers.

- Two people setting to be used in areas such as:
- Boat launching ramps with basic car and trailer parking facilities; and
  - Locations with medium use by recreational anglers.

#### ROOF STYLE

Roof designs are available in pitched, curved or skillion profiles. These are provided to accommodate particular design preferences or to ensure the selection of a design style that will complement facilities at an existing setting.

#### ROOF COLOUR

Roofs may be finished in a variety of colours to suit design preferences or to match the colour range of existing facilities. To ensure optimal visual integration with a new, natural setting, however, we recommend that the roof colours be selected from a limited palette of subtle, neutral pastels. Several appropriate colours from the *Colourbond Ultra* range include:

- Surfmist
- Dune
- Windspray

#### PLACEMENT

We recommend the following design considerations in the placement of new fish cleaning facilities:

- Ensure easy vehicle access for cleaning, maintenance and waste removal;
- Select a visibly prominent location to minimise vandalism;
- Locate the facility as close as possible to the angling activity, boat ramp or car and trailer parking to optimise use;
- Avoid blocking or impacting on water views from surrounding areas; and
- Avoid conflict with other recreational users.
- Table should be located with access to pressurised water

#### ADDITIONAL NOTES

- Always check with your local authority's policies and requirements relating to:
  - External structures
  - Drainage and disposal of waste
- Fittings and components should be inspected for wear and corrosion on an annual basis. Any damage to protective coatings should be noted for immediate repair.

Rev.	Description	Date	Des.	App.	Chk.
A	Addition of table top and minor amendments to sections	11/06/15	RE	RE	TIM

© GeoLINK 2012

This drawing must not be relied upon for any purpose other than that for which it was prepared or by any person or corporation other than the referred client.

GeoLINK

Environmental management and design

Level 1, 64 Binnia Street  
PO Box 119  
LENNOX HEAD NSW 2476  
T 02 6687 7666  
F 02 6687 7782  
Info@geolink.net.au

23 Gordon Street  
PO Box 1446  
COFFS HARBOUR NSW 2450  
T 02 6651 7666  
F 02 6651 7733

quality solutions sustainable future



Fish Cleaning Table

Client

NSW Department of Primary Industries

Designed

RE

Drawn

RE

Checked

Approved



Date

Oct 2012



XREFs

Scale

Fish Cleaning Table

Drawing List and Information

2028-1003

2028/201

A

**NOTE**  
Do not scale off drawings. Use figure dimensions only. Check all dimensions on site.

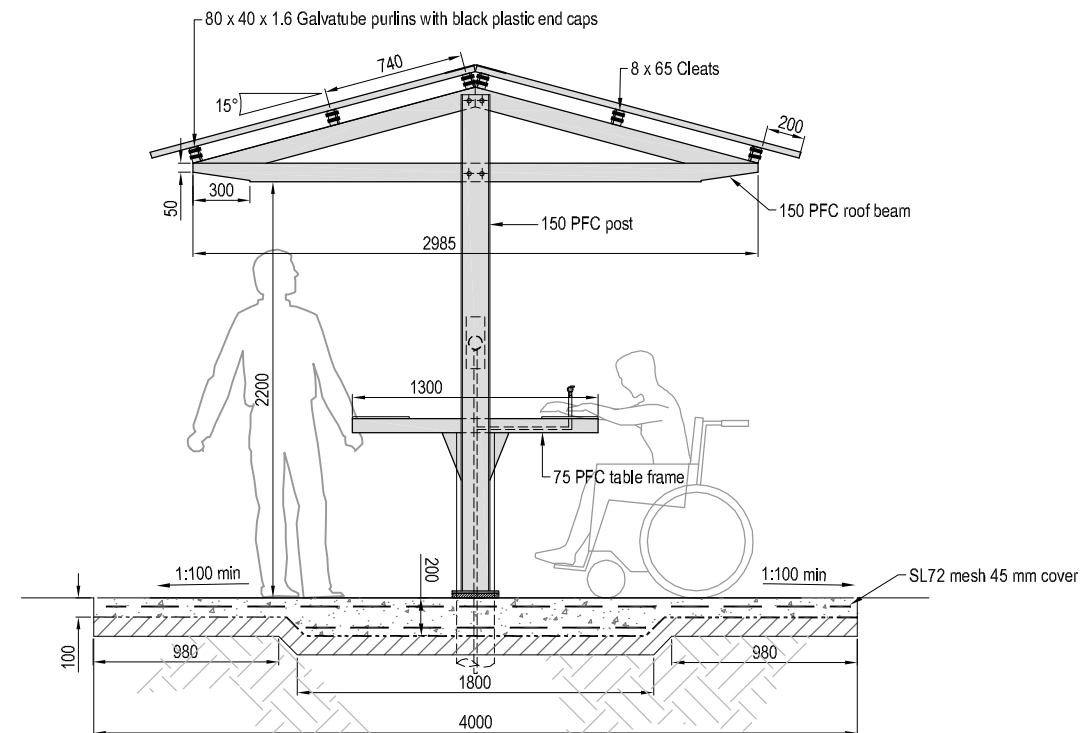
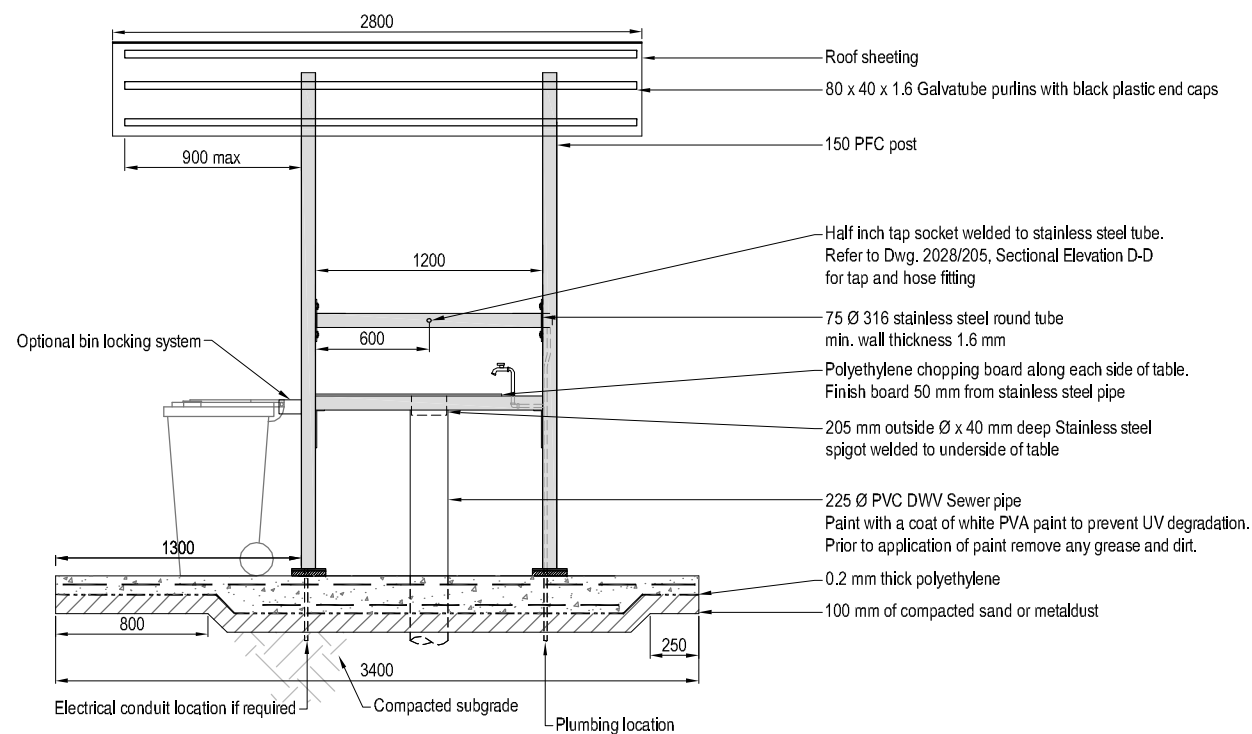

Rev	Description	Date	Des.	App.	Chk.
A	Addition of table top and minor amendments to sections	11/06/15	RE	RE	TIM

© GeoLINK 2012

This drawing must not be relied upon for any purpose other than that for which it was prepared or by any person or corporation other than the referred client.

**GeoLINK**  
environmental management and design

Level 1, 64 Belling Street  
PO Box 119  
LENNON HEAD NSW 2478  
T 02 6687 7666  
F 02 6687 7782  
Info@geolink.net.au

23 Gordon Street  
PO Box 1446  
COFFS HARBOUR NSW 2450  
T 02 6651 7666  
F 02 6651 7733

www.geolink.net.au

quality solutions sustainable future

**New South Wales Recreational Fishing Trusts**

**Fish Cleaning Table**

Client: NSW Department of Primary Industries

Designed	RE	Drawn	RE	Checked
Approved	<i>[Signature]</i>	Date	Oct 2012	<i>[Signature]</i>

XREFs

Scale: metres 0 0.20 0.40 0.60 0.80 1.00

Drawing Title

**Fish Cleaning Table**  
**Two Person Pitched Roof**

Drawing Number: 2028/202

Revision: A

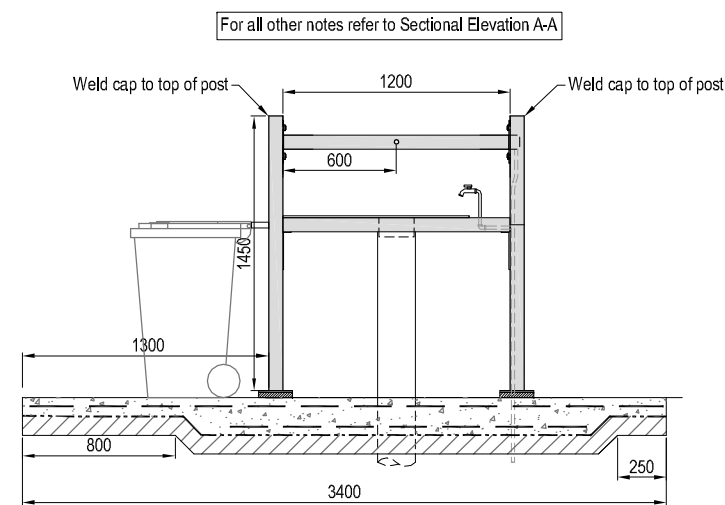
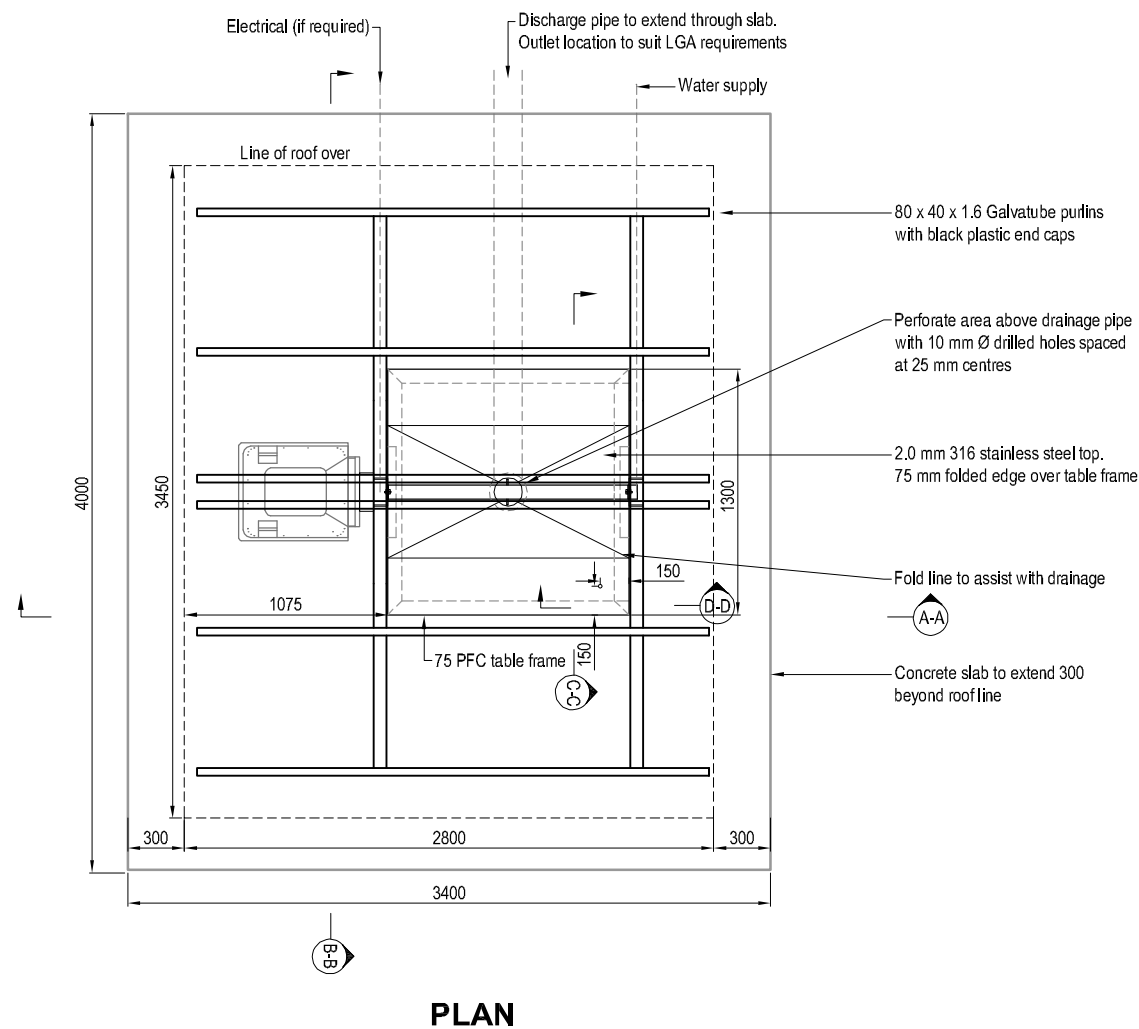

**NOTE**  
Do not scale off drawings. Use figure dimensions only. Check all dimensions on site.

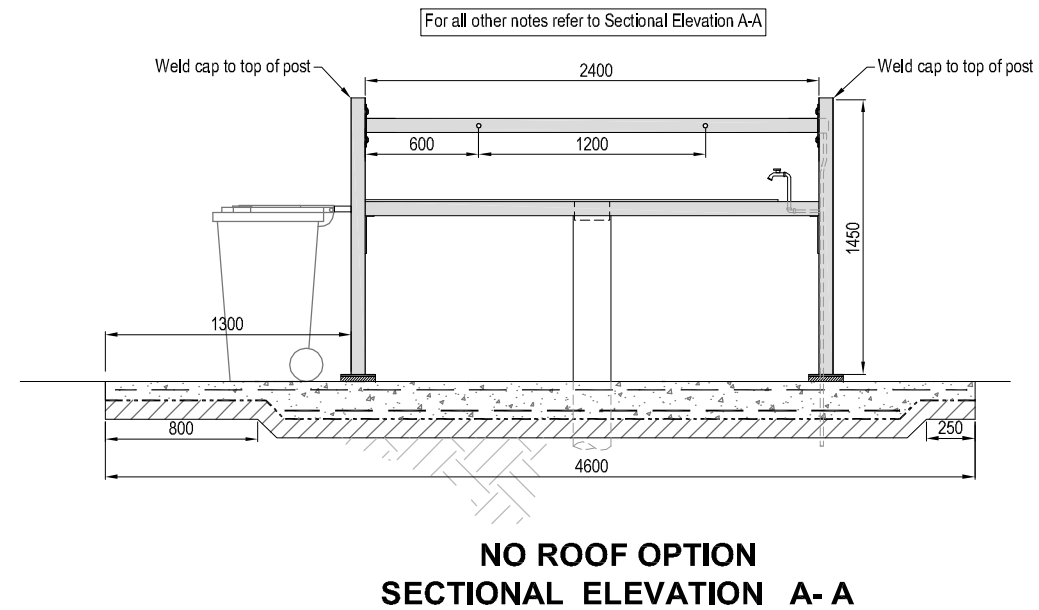
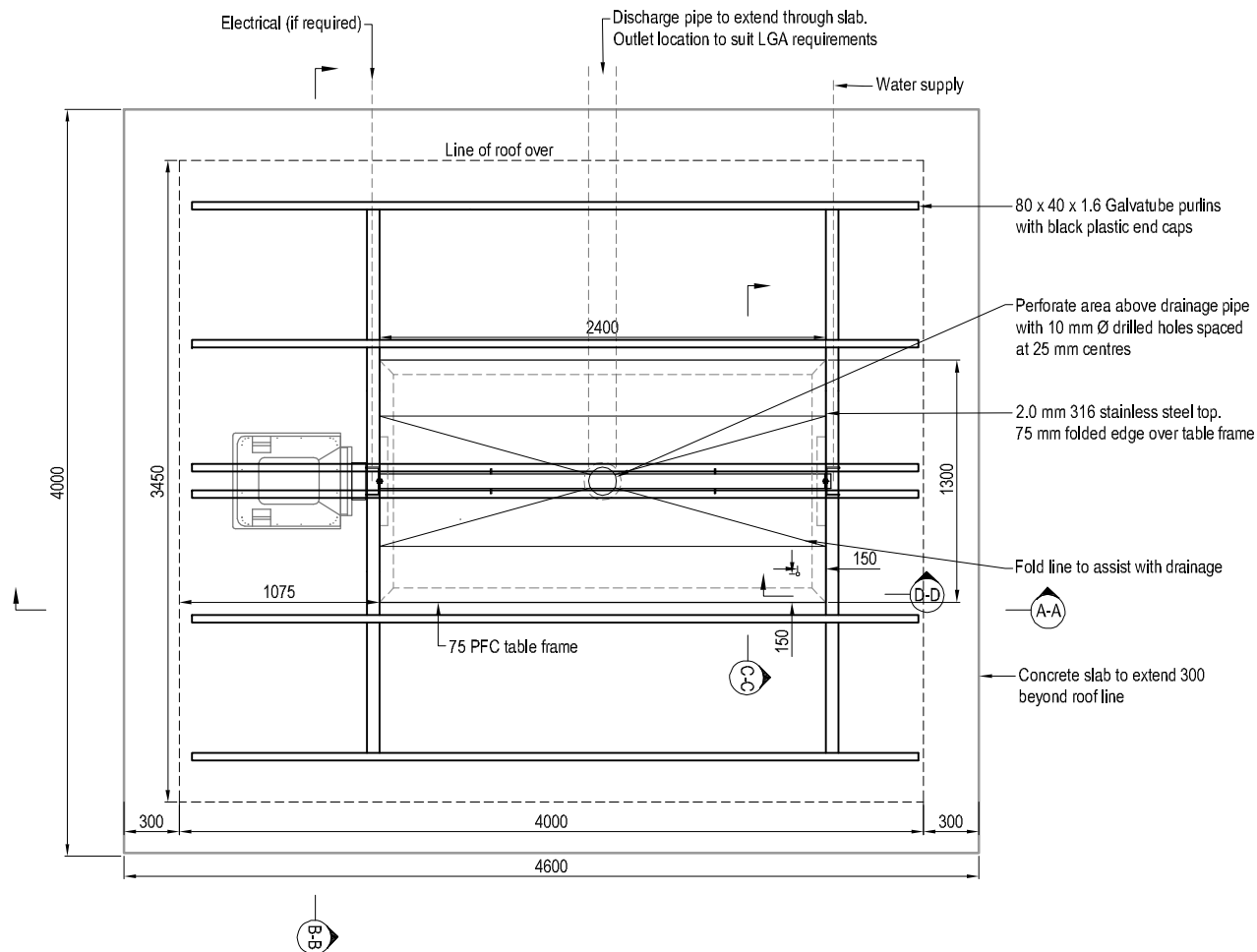
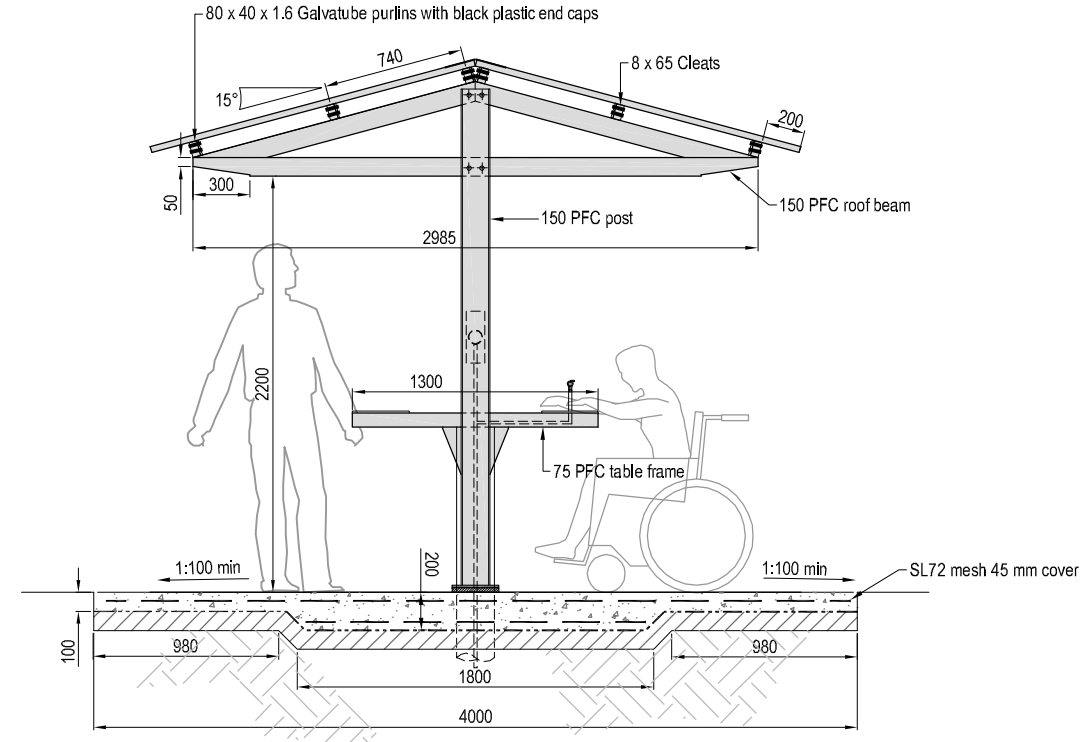
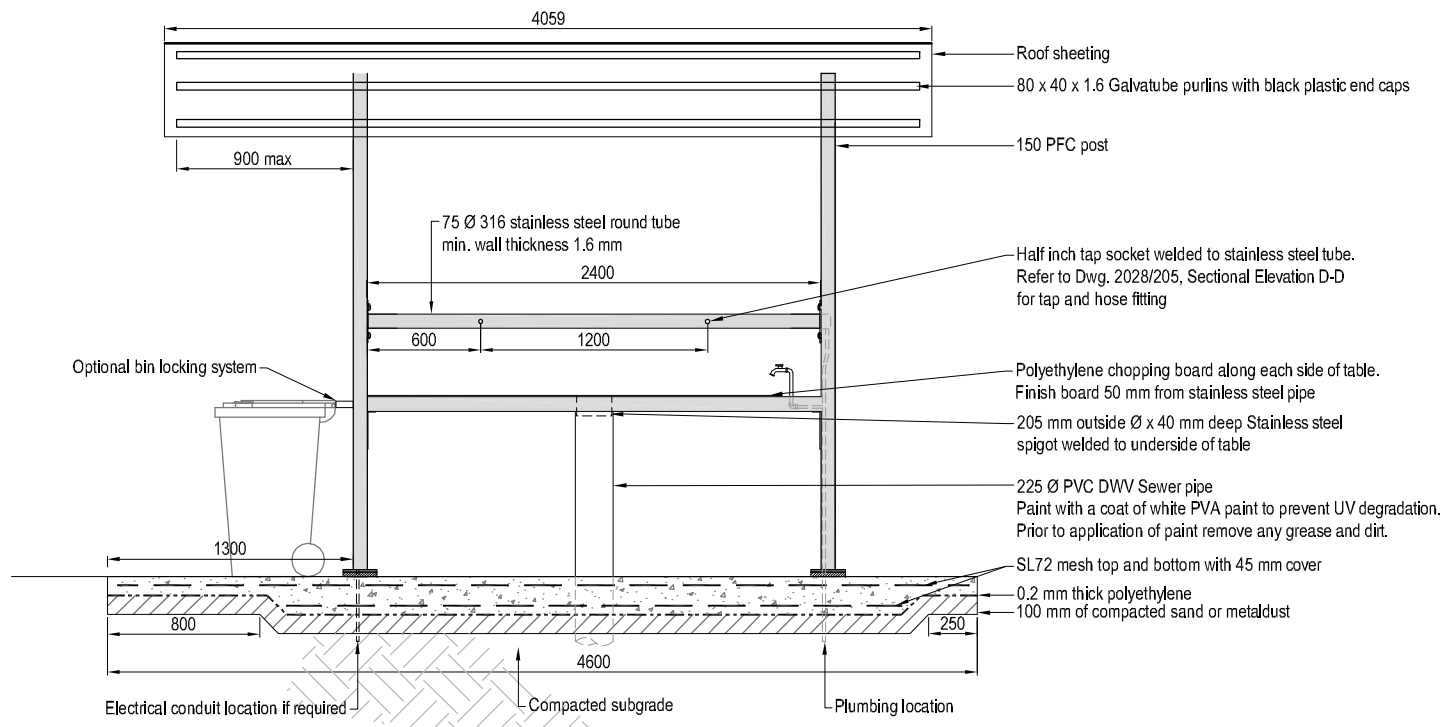

Rev	Description	Date	Des.	App.	Chk.
A	Addition of table top and minor amendments to sections	11/06/15	RE	RE	TIM

© GeoLINK 2012

This drawing must not be relied upon for any purpose other than that for which it was prepared or by any person or corporation other than the referred client.

**GeoLINK**  
Environmental management and design

Level 1, 64 Bala Street  
PO Box 119  
LENNOX HEAD NSW 2476  
T 02 6687 7666  
F 02 6687 7782  
Info@geolink.net.au

23 Gordon Street  
PO Box 1446  
COFF'S HARBOUR NSW 2450  
T 02 6651 7666  
F 02 6651 7733

www.geolink.net.au

quality solutions sustainable future

**New South Wales**  
Recreational  
Fishing Trusts

**Fish Cleaning Table**

Client: NSW Department of Primary Industries

Designed	RE	Drawn	RE	Checked	
Approved	<i>[Signature]</i>	Date	Oct 2012		<i>[Signature]</i>

XREFs

Scale: metres 0 0.20 0.40 0.60 0.80 1.00

Drawing Title

**Fish Cleaning Table**  
**Four Person Pitched Roof**

2028-1003

Drawing Number

**2028/203**

Revision

**A**

**NOTE**  
Do not scale off drawings. Use figure dimensions only. Check all dimensions on site.

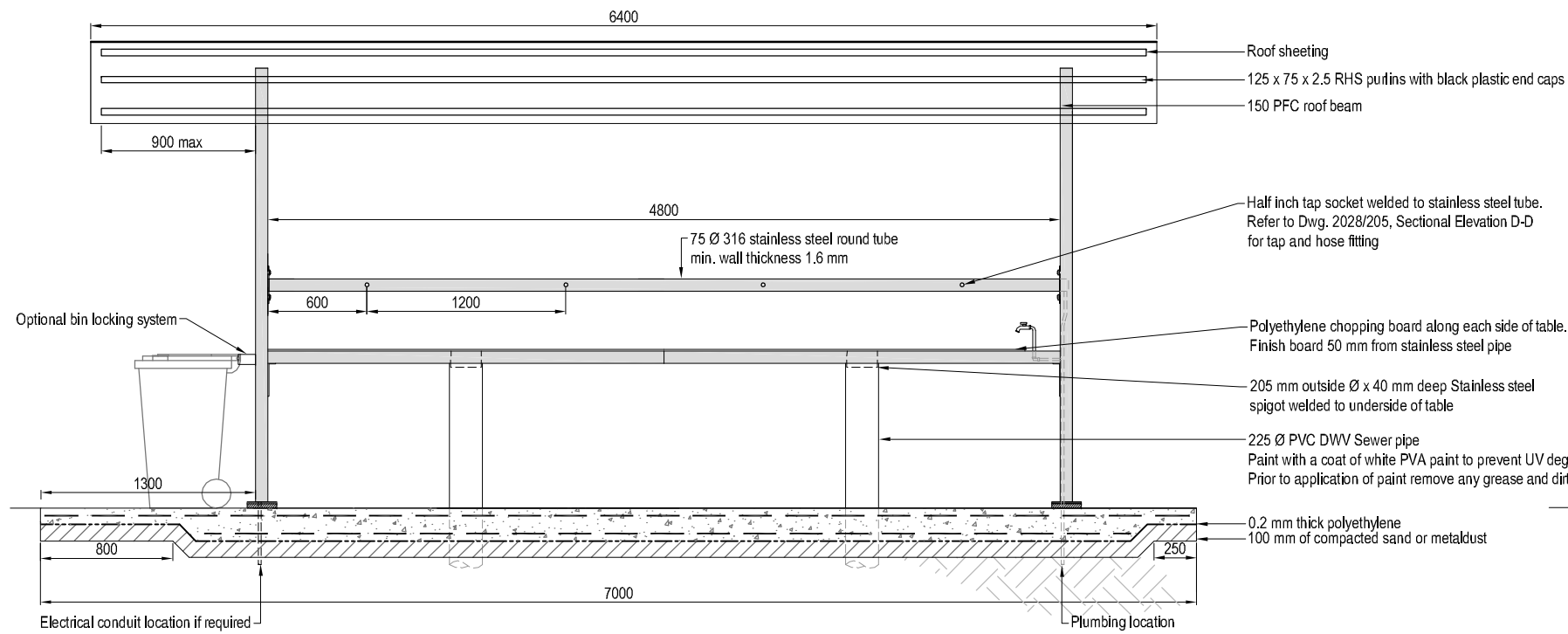

**SECTIONAL ELEVATION A-A**

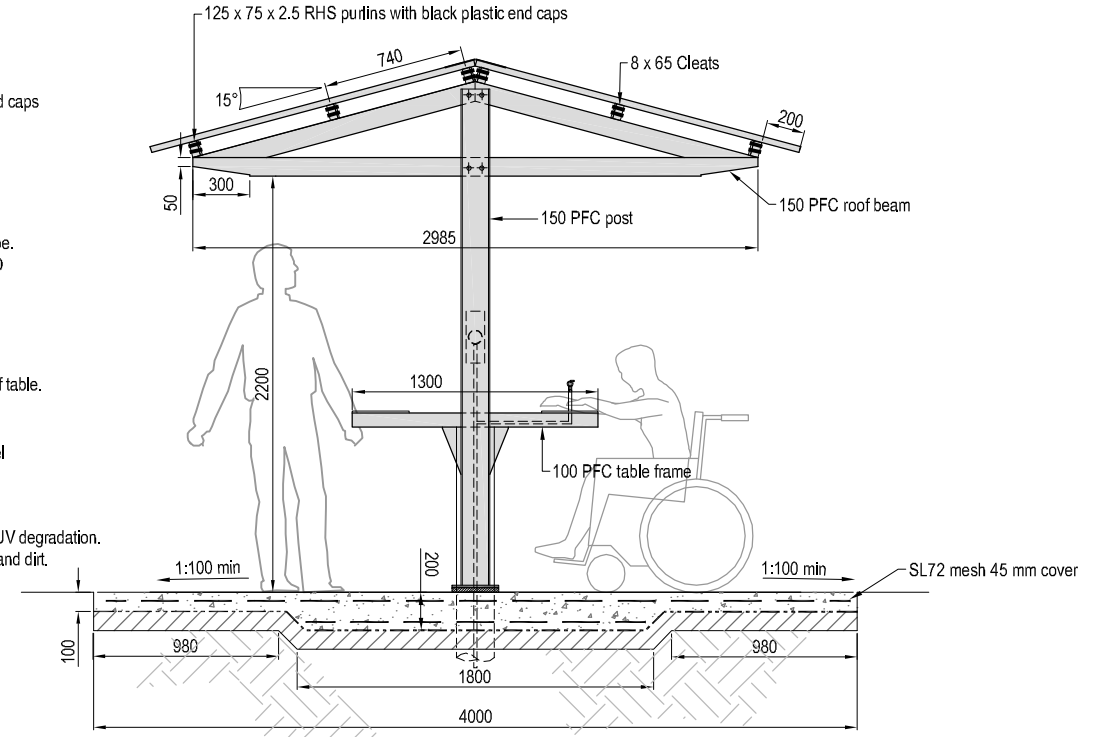

**SECTIONAL ELEVATION B-B**

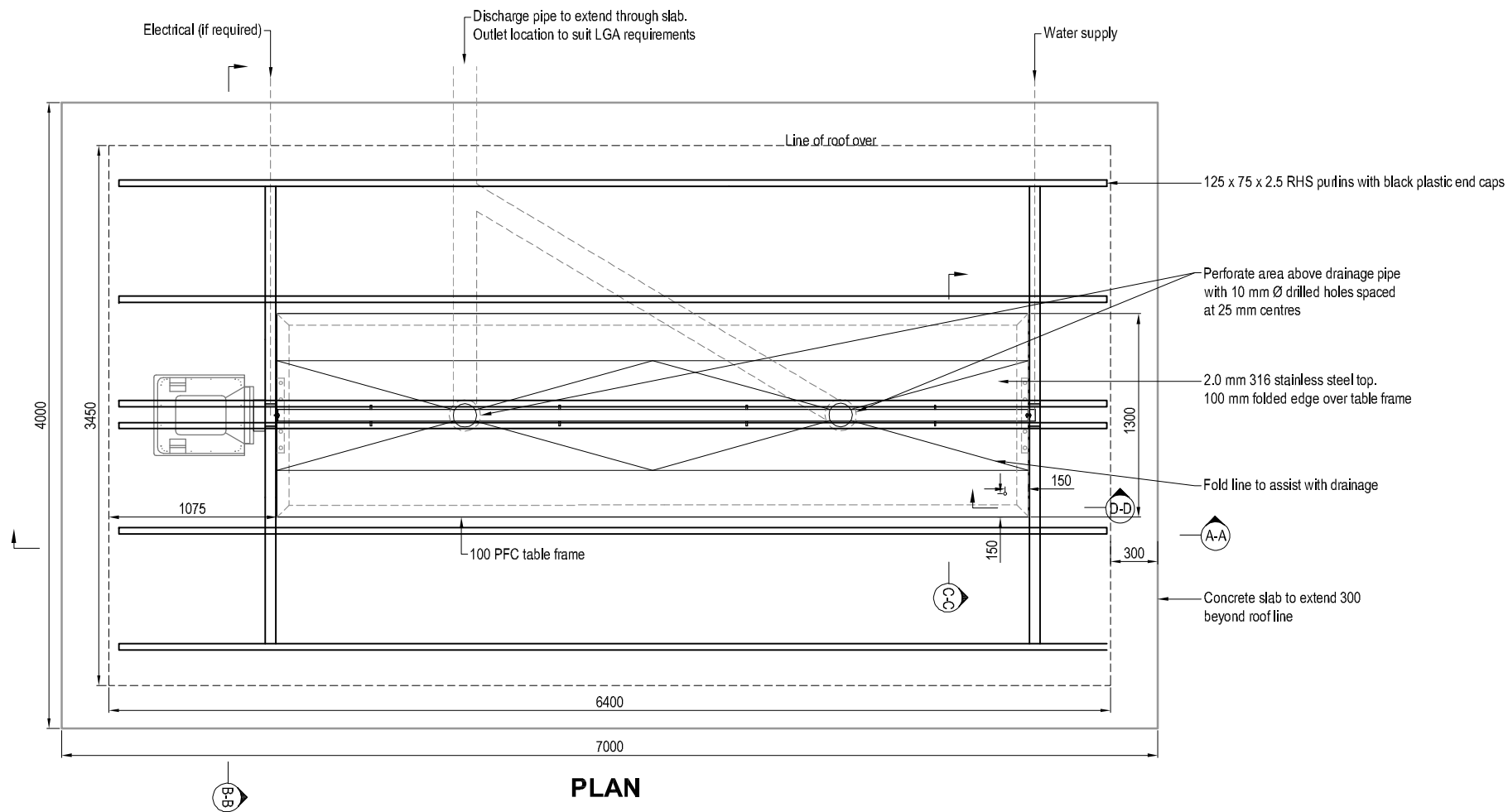

Rev.	Description	Date	Des.	App.	Chk.
A	Addition of table top and minor amendments to sections	11/06/15	RE	RE	TIM

© GeoLINK 2012

This drawing must not be relied upon for any purpose other than that for which it was prepared or by any person or corporation other than the referred client.

**GeoLINK**  
environmental management and design  
www.geolink.net.au

Level 1, 64 Ballina Street  
PO Box 119  
LENNOX HEAD NSW 2478  
T 02 6687 7666  
F 02 6687 7782  
Info@geolink.net.au

23 Gordon Street  
PO Box 1446  
COFFS HARBOUR NSW 2450  
T 02 6651 7666  
F 02 6651 7733

quality solutions sustainable future

			Project Title		
New South Wales Recreational Fishing Trusts			Fish Cleaning Table		
Client			NSW Department of Primary Industries		
Designed	RE	Drawn	RE	Checked	
Approved		Date	Oct 2012		
XREFs					
Scale					
metres 0 0.20 0.40 0.60 0.80 1.00					

Drawing Title

Fish Cleaning Table  
Eight Person Pitched Roof

Drawing Number

2028/204

Revision

A

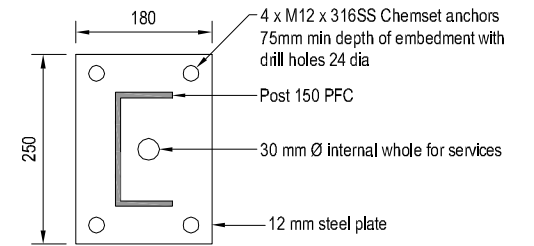
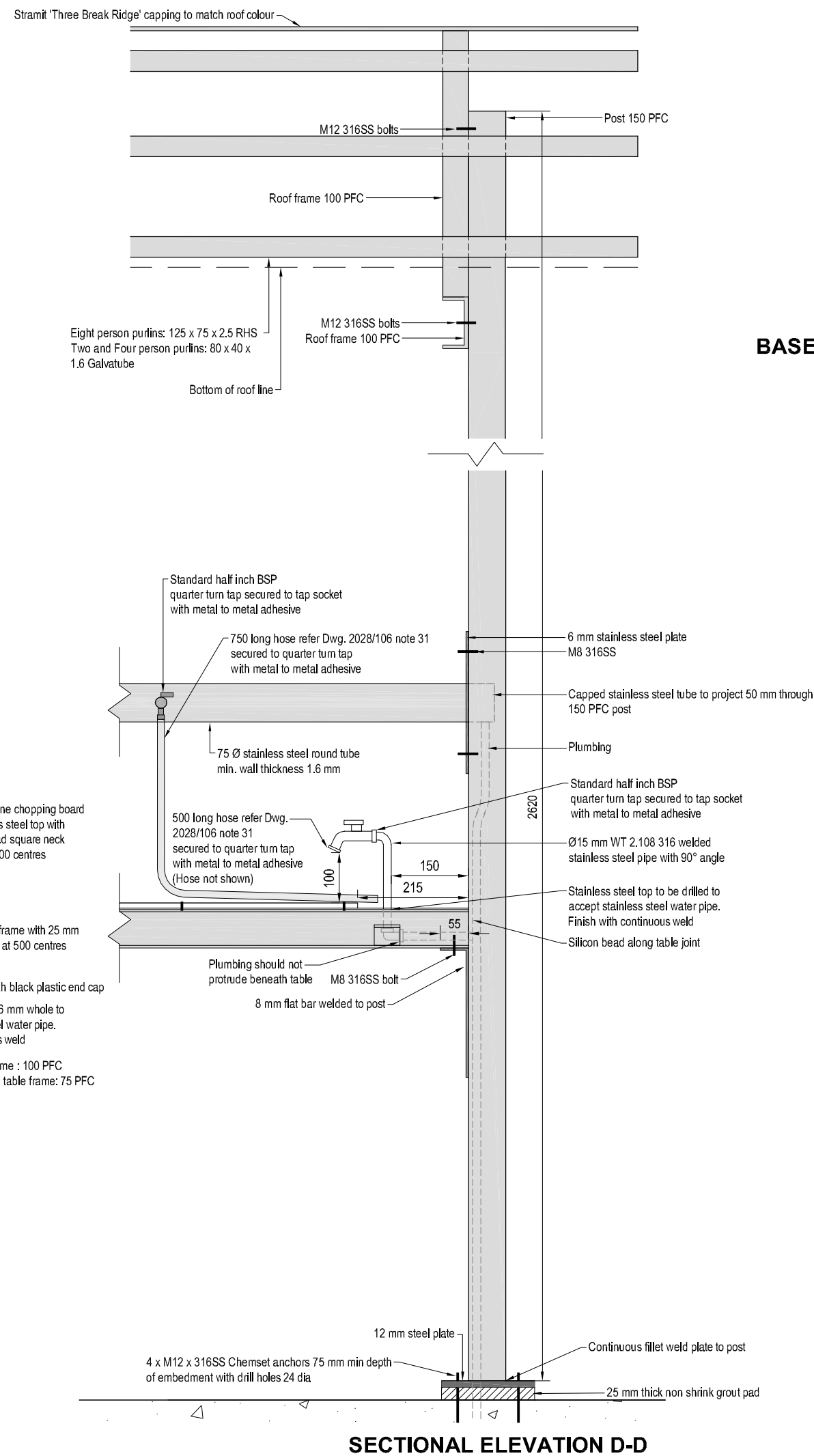
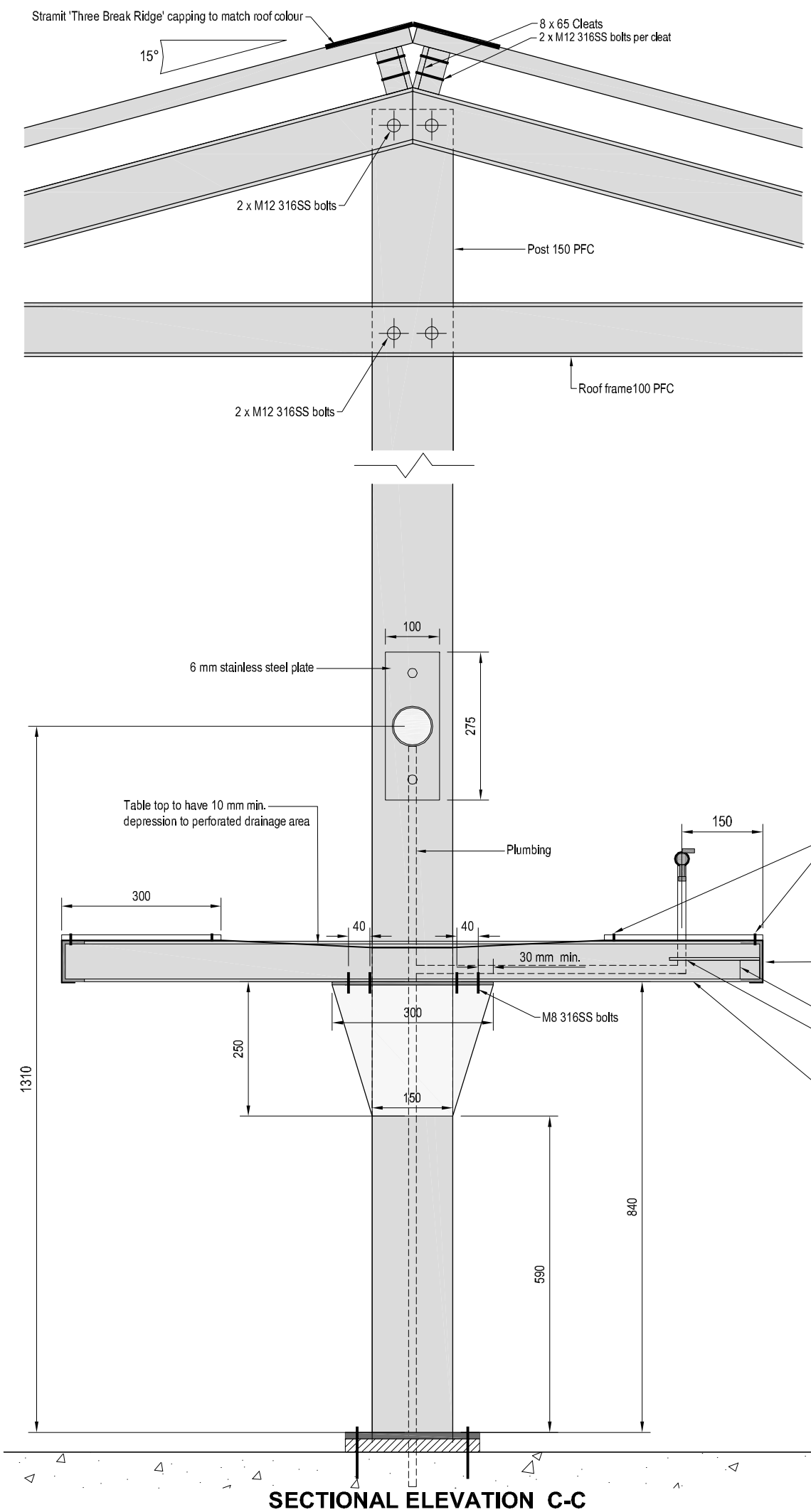

## BASE CONNECTION DETAIL

**NOTE**  
Do not scale off drawings. Use figure dimensions only. Check all dimensions on site.

Rev.	Description	Date	Des.	App.	Chk.
A	Addition of table top tap and minor amendments to sections	11/06/15	RE	RE	TIM

© GeoLINK 2012

This drawing must not be relied upon for any purpose other than that for which it was prepared or by any person or corporation other than the referred client.

**GeoLINK**  
Environmental management and design  
www.geolink.net.au

Level 1, 64 Balaclava Street  
PO Box 119  
LENNOX HEAD NSW 2478  
T 02 6687 7666  
F 02 6687 7782  
Info@geolink.net.au

23 Gordon Street  
PO Box 1446  
COFFS HARBOUR NSW 2450  
T 02 6651 7666  
F 02 6651 7733

quality solutions sustainable future

<b>New South Wales Recreational Fishing Trusts</b>		Project Title <b>Fish Cleaning Table</b>	
NSW Department of Primary Industries		Client	
Designed RE	Drawn RE	Checked P	
Approved [Signature]	Date Oct 2012		
XREFs			
Scale metres 0 0.05 0.1 0.15 0.20 0.25			

Drawing Title  
**Fish Cleaning Table  
Pitched Roof Sections and Detail**

2028-1003

Drawing Number  
**2028/205**

Revision  
**A**



## NOTES

## GENERAL

1. All materials to be free from burrs, nicks, scratches, and sharp edges
2. To assist with location and material choice refer to Dwg. 2028/201 'Information'

## CONCRETE

3. Foundation conditions to be assessed by a suitably qualified person
4. All workmanship and materials shall be in accordance with AS 3600 and AS 3610 current editions
5. Within 1km of the coast, concrete slab to be grade 40 MPa. Outside 1 km of the coast grade 32 MPa
6. SL72 mesh top and bottom with 45 mm cover
7. Nominal aggregate size: 20 mm
8. Slump: 80 mm
9. All cement shall be sulphate resistant
10. No admixtures shall be used in concrete
11. Concrete shall be compacted using mechanical vibrators
12. All concrete surfaces are to be cured by an approved method for a total of 7 days
13. Except as otherwise required, exposed concrete corners and edges shall have 20 mm chamfers

### STEELWORK (Non Stainless)

14. All workmanship and materials shall be in accordance with AS 4100 and AS 1554 except where varied by the contract documents
15. Unless noted otherwise, all steel shall be in accordance with AS 3678 and AS 3679 grade 250 and rectangular hollow sections shall be grade 350 to AS 1163
16. Bolt designation : unless noted otherwise all bolts shall be M16 grade 4.6 316 stainless steel. No connection shall have less than 2 bolts. If and T-bolts to be installed using approved load indicating washers, or by turn of nut control of tensioning
17. Unless noted, all welds shall be 6 mm continuous fillet type sp (special purpose) using E41XX electrodes. Butt welds shall be complete penetration butt welds to AS 1554
18. It is the Contractor's responsibility to ensure that steelwork is securely temporarily braced as necessary to stabilise the structure during erection
19. The Contractor shall provide all cleats and drill all holes necessary for fixing steel to steel whether or not detailed in the drawings
20. External steelwork shall be hot dipped galvanised

## STAINLESS STEEL

21. Plain finish stainless steel to be 2.0 mm 316 marine grade
22. Welded stainless steel tube to comply with AS 1769 -1975
23. 75 Ø 316 stainless steel round tube min. wall thickness 1.6 mm to be capped at both ends. Tap fittings and water supply connection to be welded to tube.

## ROOFING

24. Roof to be installed in accordance with manufactures instructions and guidelines.
25. Within 0 to 100 metres from breaking surf or exposed marine areas use Colourbond stainless steel. Within 101 to 200 metres from breaking surf or exposed marine areas use Colourbond Ultra steel. Within 201+ meters from breaking surf or exposed marine areas use Colourbond steel, Colourbond.

## GALVANISING

26. The galvanized coating on all steel articles and material lists shall conform to the requirements of AS/NZS 4680

**STANDARD FITTINGS** (Manufactures are suggested only)

30. **QUARTER TURN TAP:**  
Product: Standard Half Inch BSP quarter-turn hose end tap  
Finish: Brass

31. **WATER HOSE ON ALL TAPS:**  
 Manufacturer: Galvin Engineering  
 Contact: [www.galvinengineering.com.au](http://www.galvinengineering.com.au)  
 Product: 37412 - SS Slophopper Hose 10ID 750 X15  
 Finish: Heat Shrink Coating

- 32. CHOPPING BOARD:**  
 Manufacturer: Dotmar  
 Contact: <http://www.dotmar.com.au>  
 Product: P300 Polystone Range  
 Finish: Natural Colour

**OPTIONAL FITTINGS** (Manufactures are suggested only)

33. **BIN:** SULO  
**Manufacturer:** SULO  
**Contact:** [www.sulo.com.au](http://www.sulo.com.au)  
**Product:** Galvanised Steel Wheelie Bin or Plastic  
**Lid:** SULO Plastic Wheelie Bin 140 L Lid  
**Size:** 120 litre capacity  
**Finish:** Galvanised Steel or Plastic

34. **BIN LOCK and LID RESTRICTOR** (to suit item 33):  
 Manufacturer: SULO  
 Contact: [www.sulo.com.au](http://www.sulo.com.au)  
 Product: Single Bin, Wall Mounted, Security Bin Lock  
 and Lid Restrictor  
 Finish: Galvanised Steel

35. **WATER SAVING PUSH TAP:**  
 Manufacturer: Galvin Engineering  
 Contact: [www.galvinengineering.com.au](http://www.galvinengineering.com.au)  
 Product: 3515 15 - CP Ezy-Push® Push Button Hose Tap  
 Finish: Heavy Duty Long Lasting Bright Chrome Plate or Brass

36. **LIGHT:**  
 Manufacturer: Atom  
 Contact: [www.atomlighting.com.au](http://www.atomlighting.com.au)  
 Product: AT3301 Weatherproof Batten  
 Wattage: 1 x 14 Watt  
 Dimensions: 610 x 60 x 75 mm

A	Addition of table top tap and minor amendments to sections	11/06/15	RE	RE	TIM
Rev.	Description	Date	Des.	App.	Chk.

Amendments

© GeoLINK 2012

This drawing must not be relied upon for any purpose other than that for which it was prepared or by any person or corporation other than the referred client.



quality solutions sustainable future

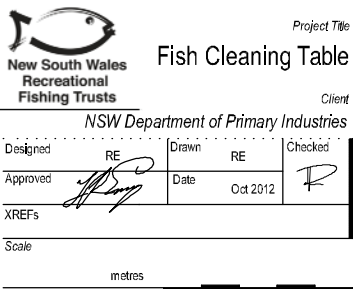

# Fish Cleaning Table Notes